

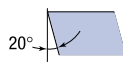

S E K N



Shape
Square 90°



Clearance Angle
20°

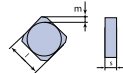

Tolerance
l ± 0.08 m ± 0.013
s ± 0.025



Insert Type
Clamping
No chip breaker

Insert designation	Grade	l	s	P/r	D	Direction	Catalog Nr.	Page
SEKN 1203 AFTN	LT 30	12	3,18	45°	25°	Neutral	M0000041	187
SEKN 1204 AFTN	LT 30	12	4,76	45°	25°	Neutral	M0000042	187
SEKN 1504 AFTN	LT 30	15	4,76	45°	25°	Neutral	M0000450	188

Surfacing Insert Lead angle 45°

Application Guide **SEKN**



Multi purpose 45° milling inserts, designed for high depths of cut. Suitable for Roughing to Finishing - Face, Plunging and Ramping down milling operations.

Machining Recommendation Guide - Please see Pg. 8

Catalog Nr.	Description	D	De	d	H	Ap	z
M2000563	LT 550 M-D50	50	63	22	48	6	4
M2000564	LT 550 M-D63	63	76	22	48	6	5
M2000565	LT 550 M-D80	80	93	27	50	6	6
M2000566	LT 550 M-D100	100	113	32	50	6	6
M2000567	LT 550 M-D125	125	138	40	63	6	7
M2000568	LT 550 M-D160	160	173	40	63	6	7
M2000569	LT 550 M-D200	200	213	60	63	6	10
M2000570	LT 550 M-D250	250	263	60	63	6	13

Screw set: CVB 55 Key set: ET 4 

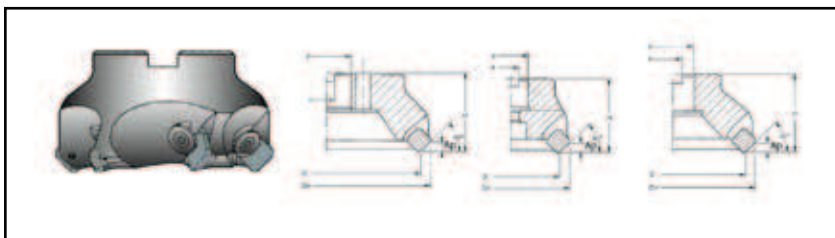

Material Group	Group No	Material Examples*	Brinell hardness	d.o.c [mm]		feed [mm/tooth]		V _c [m/min]	
				min	max	min	max	min	max
Low Carbon Steel	1	Ck15, Ck45 1020, 1045	150	0.5	7.0	0.20	0.32	190	350
			180		7.0		0.32		300
			210		7.0		0.32		260
Alloy Steel	2	42 CrMo 4 St 50-2 Ck60 1060 4140	180	0.5	7.0	0.20	0.30	150	240
			230		7.0		0.30		210
			280	0.5	7.0	0.20	0.30	130	190
			320		7.0		0.30		170
High Alloy Steel	3	X40 CrMoV 5 1 H 13 40 NiCrMo 6 4340 S 2-10-1-8 HSS M42	220	0.5	7.0	0.15	0.25	90	150
			280		7.0		0.25		130
			320	0.5	7.0	0.15	0.25	60	110
			350		7.0		0.25		90
			400	0.5	5.0	0.12	0.24	40	80
			480		3.0		0.22		70
			550		1.5		0.20		60
Austenitic Stainless Steel	4	X5 CrNi 18 9 304	210 to 250	0.5	7.0	0.18	0.32	190	250
	5	X2 CrNiMo 17 2 2 316	230 to 270	0.5	5.0	0.15	0.28	160	210
	6	X6 CrNiMoTi 17 12 2 316 Ti Duplex / Nitronic	-----	0.5	5.0	0.12	0.25	70	150
Ferritic Stainless Steel	7	X8 Cr 7 430	Annealed	0.5	7.0	0.12	0.32	150	210
Martensitic Stainless Steel	8	X15 Cr 13 410	Annealed	0.5	7.0	0.12	0.32	150	230
			Treated	0.5	5.0	0.12	0.28	90	170
Grey Cast Iron	9	GG 20	140 to 230	0.5	7.0	0.15	0.40	170	300
GG 25		250							
GG 30		210							
Nodular Cast Iron	10	GGG 40	210	0.5	7.0	0.12	0.32	120	210
		GGG 50	260						170
		GGG 70	310						150
		G-X260NiCr42	450						0.5
Nickel Based Alloys	11	Inconel 625	-----	0.5	5.0	0.12	0.28	25	35
		Inconel 718						28	40
		Hastelloy C						40	60
Titanium Based Alloys	12	TiAl 6 V4	-----	0.5	5.0	0.12	0.32	35	60
		T40					0.28	28	40

SEKN



Material Group	Group No	Material Examples*	Brinell hardness	d.o.c [mm]		feed [mm/tooth]		V _c [m/min]	
				min	max	min	max	min	max
Low Carbon Steel	1	Ck15, Ck45 1020, 1045	150	0.5	9.0	0.20	0.52	190	350
			180		9.0		0.52		300
			210		9.0		0.52		260
Alloy Steel	2	42 CrMo 4 St 50-2 Ck60 1060 4140	180	0.5	9.0	0.20	0.48	150	240
			230		9.0		0.48		210
			280	0.5	9.0	0.20	0.45	130	190
			320		9.0		0.45		170
High Alloy Steel	3	X40 CrMoV 5 1 H 13 40 NiCrMo 6 4340 S 2-10-1-8 HSS M42	220	0.5	9.0	0.15	0.42	90	150
			280		9.0		0.42		130
			320	0.5	9.0	0.15	0.38	60	110
			350		9.0		0.38		90
			400	0.5	5.0	0.12	0.32	40	80
			480		3.0		0.28		70
			550		1.5		0.26		60
Austenitic Stainless Steel	4	X5 CrNi 18 9 304	210 to 250	0.5	7.0	0.25	0.35	190	250
	5	X2 CrNiMo 17 2 2 316	230 to 270	0.5	7.0	0.23	0.32	160	210
	6	X6 CrNiMoTi 17 12 2 316 Ti Duplex / Nitronic	-----	0.5	7.0	0.18	0.28	70	150
Ferritic Stainless Steel	7	X8 Cr 7 430	Annealed	0.5	9.0	0.23	0.38	150	210
Martensitic Stainless Steel	8	X15 Cr 13 410	Annealed	0.5	9.0	0.18	0.38	150	230
			Treated	0.5	9.0	0.18	0.32	90	170
Grey Cast Iron	9	GG 20	140 to 230	0.5	9.0	0.25	0.60	170	300
		GG 25							250
		GG 30							210
Nodular Cast Iron	10	GGG 40	210	0.5	9.0	0.18	0.50	120	210
		GGG 50	260						170
		GGG 70	310						150
		G-X260NiCr42	450						0.5
Nickel Based Alloys	11	Inconel 625	-----	0.5	7.0	0.18	0.32	25	35
		Inconel 718						28	40
		Hastelloy C						40	60
Titanium Based Alloys	12	TiAl 6 V4	-----	0.5	7.0	0.18	0.32	35	60
		T40					0.28	28	40